

92-B-56 - SPEEDLINE System Data Sheet - Version V1 (24-10-23)

SPEEDLINE 92mm 'C' Stud Partition @600mm Ctrs,
with BG Gyproc 15mm FireLine each side,

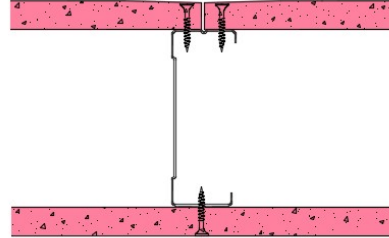

System Performance Breakdown

Fire Resistance:

BS476 Part 22:1987:

Test Ref & Date or Applied Ref & Report:

Max Height:

Thickness:

Duty Grade: BS 5234: Part 2:1992:

Sound Insulation:

60/60 Minutes (Integrity/Insulation).

BTC 17441F - BRE Report P102396-1011A

Refer to Speedline Specification Clause

124 mm. (At Base Track, Excluding Finishes)

Heavy - Annexes A-F

39 R_w dB, Date Tested or Assessed Against - 70-B-56

APPENDIX A - TEST DATA

Test Code:
H21047AA
Test Date:
19/07/2019

| Freq. Hz | R dB |
|-------------|---------|
| 50 | 25.5 |
| 63 | 16.0 |
| 80 | 9.8 |
| 100 | 12.6 |
| 125 | 13.6 |
| 160 | 27.5 |
| 200 | 31.8 |
| 250 | 32.8 |
| 315 | 34.9 |
| 400 | 39.7 |
| 500 | 41.7 |
| 630 | 44.0 |
| 800 | 48.9 |
| 1 000 | 51.0 |
| 1 250 | 52.5 |
| 1 600 | 49.3 |
| 2 000 | 38.8 |
| 2 500 | 37.3 |
| 3 150 | 41.3 |
| 4 000 | 44.4 |
| 5 000 | 48.9 |

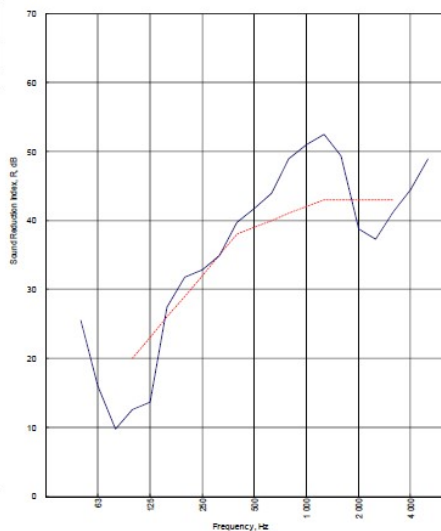

Rating according to BS EN ISO 717-1:2013
 R_w (C;Ctr) = 39 (-3;-9) dB
 Max dev. 9.4 dB at 125 Hz

| | | |
|-------------------------|-------------------------|-------------------------|
| $C_{50-3150}$ -4 dB | $C_{50-5000}$ -3 dB | $C_{100-5000}$ -2 dB |
| $C_{e, 50-3150}$ -12 dB | $C_{e, 50-5000}$ -12 dB | $C_{e, 100-5000}$ -9 dB |

TESTED AT ONE OF THE UKAS ACCREDITED LABORATORIES BELOW

| | |
|---------------------------|--|
| B.T.C (H-Ref on Graph) | |
| B.R.E | |
| AIRO | |
| S.R.L | |

Customer: Voestalpine Metsec Plc Dry Lining



BTC 21047A: Page 10 of 13

SPEEDLINE Drywall Systems, Adsetts House, 16 Europa View, Sheffield Business Park, Sheffield, S9 1XH.

Tel: 0114 231 8030.

Email: enquiries@speedlinedrywall.co.uk

(As per the requirements set out in ISO/IEC 17025:2017 regarding test data the results stated have been carried out by voestalpine Metsec plc as part of the contract to supply Speedline Metal Sections to SIG Plc)